

Tying capacity

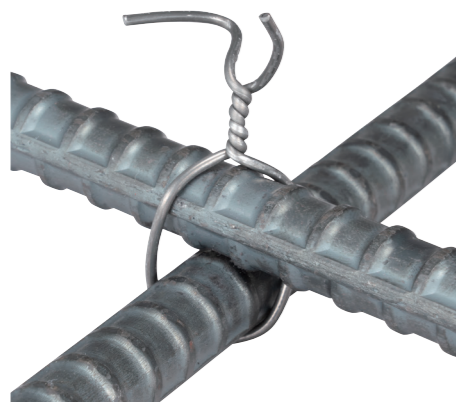

	Two-rebar tying combinations					
	D10(#3)	D13(#4)	D16(#5)	D19(#6)	D22(#7)	D25(#8)
D10(#3)	✓					
D13(#4)	✓	✓				
D16(#5)	✓	✓	✓			
D19(#6)	✓	✓	✓	✓		
D22(#7)	✓	✓	✓	✓	✓	
D25(#8)	✓	✓	✓	✓	✓	✓
D29(#9)	✓	✓	✓	✓	✓	✓
D32(#10)	✓	✓	✓	✓	✓	✗
D35(#11)	✓	✓	✓	✓	✗	✗

	Three-rebar tying combinations					
	D10xD10 (#3x#3)	D13xD13 (#4x#4)	D16xD16 (#5x#5)	D19xD19 (#6x#6)	D22xD22 (#7x#7)	D25xD25 (#8x#8)
D10(#3)	✓	✓	✓	✓	✓	✓
D13(#4)	✓	✓	✓	✓	✓	✗
D16(#5)	✓	✓	✓	✓	✗	✗
D19(#6)	✓	✓	✓	✓	✗	✗
D22(#7)	✓	✓	✓	✓	✗	✗
D25(#8)	✓	✓	✓	✓	✗	✗
D29(#9)	✓	✓	✓	✗	✗	✗
D32(#10)	✓	✓	✓	✗	✗	✗

	Four-rebar tying combinations		
	D10xD10 (#3x#3)	D13xD13 (#4x#4)	D16xD16 (#5x#5)
D10xD10 (#3x#3)	✓		
D13xD13 (#4x#4)	✓	✓	
D16xD16 (#5x#5)	✓	✓	✓

(# means perimeter length: cm)

Accessories

Tie wire set (32 pcs)

Part No. 1915N0-0

A set of annealed tying wire wound onto a wire reel.



Extension handle set

Part No. 1915N6-8

This handle enables the operator to tie rebars while standing by attaching the tool to this handle.



Charging Time

	DC40RA	DC40RC
*1 BL4020 2.0Ah	22 min	30 min
*1 BL4025 2.5Ah	28 min	38 min
*1 BL4040/F 4.0Ah	45 min	67 min
*1 BL4050F 5.0Ah	50 min	85 min
BL4080F/H 8.0Ah	76 min	170 min

*1 Recommended battery

Cordless Rebar Tying Tool

TR001G

Anti-restart function	Applicable rebar for tying	D10 x D10 - (D16 x 2) x (D16 x 2)
Carrying Case	Applicable tie wire	Annealed wire: 16Ga (1.6 mm)
	Tying speed	0.7 s
	Tying strength adjustment	6 Stages
	Number of ties	Per reel: 240 / On a full battery charge (BL4040): 3,900
	Wire tail height	16 mm (5/8")
	Nose width	5.6 mm (7/32")
	Vibration level	2.5 m/s ² or less (EN60745-2-18, Mode: Tying metal rod)
	Uncertainty (K) for Vibration	1.5 m/s ² (EN60745-2-18, Mode: Tying metal rod)
	Sound pressure level	80 dB (A) (EN60745-2-18)
	Sound power level	88 dB (A) (EN60745-2-18)
	Uncertainty (K) for Noise	3 dB (A) (EN60745-2-18)
	Dimensions (L x W x H)	375 x 113 x 331 mm (14-3/4 x 4-7/16 x 13")
	(Battery)	BL4040
	Net weight	3.3 - 4.5 kg (7.3 - 9.9 lbs.)
	(Battery)	BL4020 - BL4080F
	(Attachment)	w/o Wire

Standard Equipment : Hex wrench, Hook, Oil supply, Battery, Charger

The net weight value includes the lightest and heaviest combination of the attachment(s) for normal and safe use and battery cartridge(s) which are specified in the instruction manual.
Items of standard equipment and specifications may vary by country or area.

Makita Corporation

3-11-8 Sumiyoshi-cho, Anjo, Aichi, 446-8502 Japan

PRINTED IN JAPAN 202509



www.makita.com



Cordless Rebar Tying Tool TR001G



Excellent combination of high tying strength and speed



Tying strength*
[ø1.6mm wire]

180% Higher

Compared to our 18V model

*Relative value of torque to move one of the cross-tied D13 x D13 rebars



Fast and strong tying for a wide range of rebar combinations

XGT
40V Li-ion max + **BL MOTOR**

Powered by an XGT battery and equipped with BL motors, the tool delivers high tying strength and speed using 1.6mm wire.



BL motors (for twisting and feeding)

Dual BL motors, one for twisting and one for feeding, ensure stable tying with 1.6mm wire.

Tying strength*

TR001G
[ø1.6mm wire]

280

Our 18V model
[ø0.8mm wire]

100

*Relative value of torque to move one of the cross-tied D13 x D13 rebars

For annealed wire only (ø1.6mm)



Capable of tying a wide range of rebar sizes, from small to large diameters.

Wire pullback mechanism

Equipped with a wire pullback mechanism, the tool pulls back the wire while holding its tip, allowing the rebars to be tightly and securely tied.

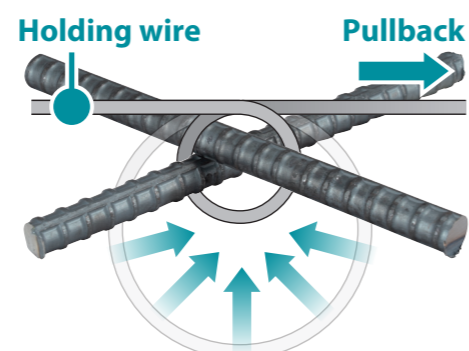

Easy loading of tying wire

When the cover is opened, the linked reel cover and wire feed mechanism create a gear gap for one-step wire reel loading.

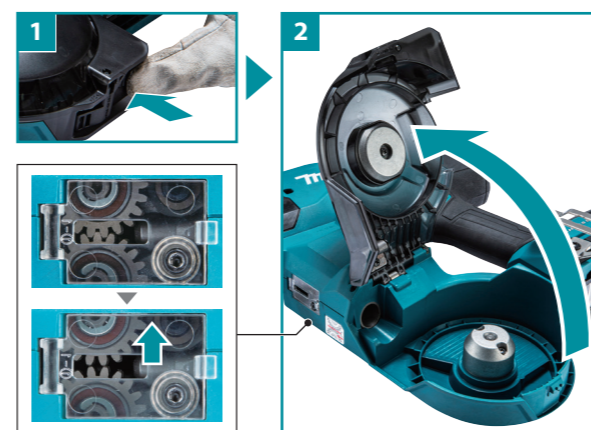

Clockwise wire twisting

Clockwise wire twisting, which is common in manual tying, minimizes the chance of unintentional loosening when retightening by hand.

